

Product datasheet

Overhead sectional door

ASSA ABLOY OH1042S

ASSA ABLOY
Entrance Systems

Experience a safer
and more open world



Copyright and Disclaimer Notice

Although the contents of this publication have been compiled with the greatest possible care, ASSA ABLOY Entrance Systems cannot accept liability for any damage that might arise from errors or omissions in this publication. We also reserve the right to make appropriate technical modifications/replacements without prior notice.

No rights can be derived from the contents of this document.

Color guides: Color differences may occur due to different printing and publication methods.

No part of this publication may be copied or published by means of scanning, printing, photocopying, microfilm or any other process whatsoever without prior permission in writing by ASSA ABLOY Entrance Systems.

Copyright © ASSA ABLOY Entrance Systems AB 2006-2021.

All rights reserved.

ASSA ABLOY, Besam, Crawford, Albany and Megadoor as words and logo are trademarks belonging to the ASSA ABLOY Group.

Technical Overview

Features

Max size: (W x H)	5000 x 5000 mm
Panel thickness:	42 mm
Panel material:	Diamond grid
Filling:	CFC-free polyurethane, flame retardant DIN 4102-B2
Weight	13 kg/m ²
Color outside:	14 standard RAL colors
Color inside:	RAL 9002
Track types:	Standard: SL Optional: HL, VL
Windows:	Optional: DARP, TARP, DAOP, ALRB, ALBS, Framed section
Passdoor:	Not possible in the OH1042S
Electrical operation:	Optional: Automated operation, Access control, Safety functions

Performance

Opening/closing speed:	Opening ≈1,0 m/s, Closing 0,7 m/s	
Life time expectations:	Door: 200.000 door cycles or 10 years, if service/replacement program is performed Springs: 20.000 door cycles, optional max.100.000 depending door configuration.	
Resistance to wind load, EN12424	Insulated panel sections	Class 3 (DLW ≤ 4250) Class 2 (4250 < DLW) (Higher classes on request)
	Framed sections nr. 2 and 3	Class 3 (DLW ≤ 3650); Class 2 (3650 < DLW ≤ 4550) (Bigger DLW possible for framed in section 4 and up)
Thermal transmittance, EN12428	1,0 W/(m ² ·K) full panel (Door size 5000 x 5000 mm) Thermal calculations on exact door sizes and configurations are available on request	
Resistance to Water penetration, EN12425	Class 3	
Air permeability, EN12426	Class 3	
Acoustic insulation, EN ISO 10140-2	R - 25 dB	

Contents

Copyright and Disclaimer Notice	2
Technical Overview	3
Contents	4
1. Description	6
1.1 General	6
1.2 Dimensions	6
1.2.1 Daylight width and daylight height	6
1.2.2 Section sizes	6
1.3 Door leaf	6
1.3.1 Construction	6
1.3.2 Material	7
1.3.3 Vertical cross-section	7
1.3.4 Colors	8
1.3.5 Seals	8
1.3.6 Wind reinforcement truss	9
1.3.7 Handle	9
1.3.8 Lock bolt	9
1.4 Balancing system	10
1.4.1 Safety devices	10
1.5 CEN Performance	11
1.5.1 Lifetime expectation	11
1.5.2 Resistance to windload	11
1.5.3 Resistance to water penetration	11
1.5.4 Air permeability	11
1.5.5 Thermal transmittance	12
1.5.6 Acoustic insulation	12
1.5.7 Operating forces and safe openings	12
1.6 Track sets	13
1.6.1 General	13
1.6.2 SL - Standard Lift	13
1.6.3 HL - High Lift	13
1.6.4 VL - Vertical Lift	13
2. Available Options	14
2.1 Fixed sections	14
2.1.1 Fixed sections options	14
2.2 Windows	15
2.2.1 DARP	15
2.2.2 TARP	15
2.2.3 DAOP	15
2.2.4 ALRB	15
2.2.5 ALBS	15
2.2.6 Framed sections	16
2.2.7 Number of windows	16
2.2.8 Windows	16
2.3 Optional colors*	16
2.4 Cylinder lock	17

3.	Operating system	18
3.1	Type of operation	18
3.2	Electrical operation.....	18
3.3	950 Door control system.....	18
3.4	CMD9S Operator	18
3.5	Guidelines for automation.....	19
3.6	Access and automation.....	20
3.6.1	Basic control functions.....	20
3.6.2	External control functions.....	20
3.6.3	Automatic control functions.....	20
3.6.4	Safety functions.....	21
3.6.5	Additional functions.....	22
4.	Building and space requirements	23
4.1	Building preparations	23
4.1.1	Installation preparations.....	23
4.2	Space requirements	23
4.2.1	Space requirements SL	24
4.2.2	Space requirements HL	25
4.2.3	Space requirements VL.....	26
5.	Service you can rely on	27
	Index	28

1. Description

1.1 General

The ASSA ABLOY OH1042S overhead sectional speed door, with its modern, clean design, is one of the fastest and well-insulated overhead doors on the market.

With an opening speed of approximately one meter per second, the ASSA ABLOY OH1042S is designed for businesses with frequently used doors, vehicles of different height, better temperature control, regular door-collisions or an interest in reducing noise and dust.

The ASSA ABLOY OH1042S overhead sectional door has been designed to meet all operational and safety requirements in the European Directives and the standards issued by the European Standardization Committee, CEN.

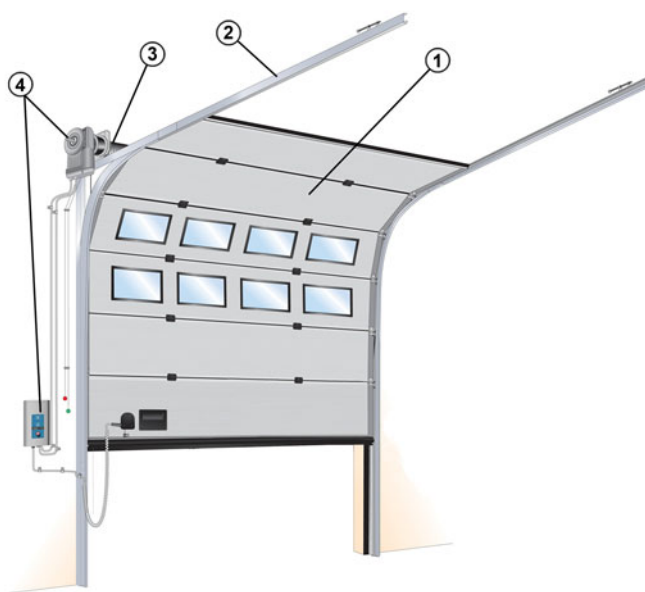

The door has 4 primary parts:

- 1) Door leaf
- 2) Track set
- 3) Balancing system
- 4) Operating system

1.2 Dimensions

1.2.1 Daylight width and daylight height

The standard ASSA ABLOY OH1042S overhead sectional door is delivered in the following size range:

	Daylight width	Daylight height
Min.:	2000 mm	2750 mm
Max.:	5000 mm	5000 mm

1.2.2 Section sizes

Section height:	545 mm
Top section height:	275 - 820 mm trimcut
Thickness:	42 mm

The door leaf height is achieved by trimcutting the top section.

1.3 Door leaf

1.3.1 Construction

The ASSA ABLOY OH1042S overhead sectional door leaf has horizontal sections, connected together with hinges. The outer hinges of each section have rollers that run in the tracks. The horizontal sections are insulated panels designed without thermal bridges for optimal insulation. The panels are filled with water blown CFC-free polyurethane.

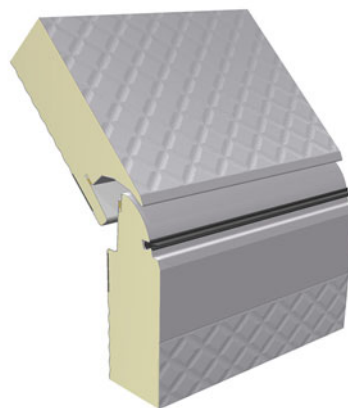

1.3.2 Material

The surface of the door leaf panels is a characteristic diamond grid steel sheet. The pre-coated steel door leaf panels fulfill outdoor corrosion resistance category RC3 according to EN 10169.

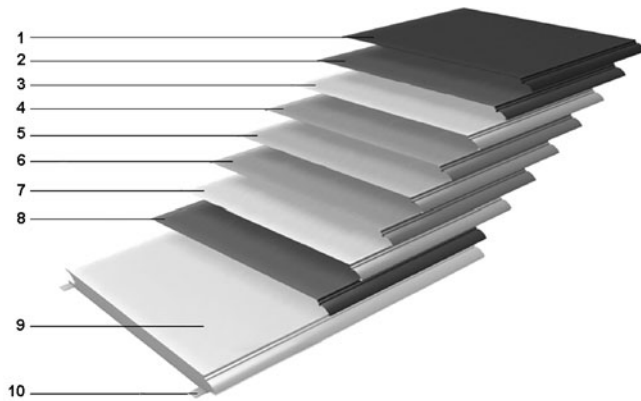

- 1) Polyester coating
- 2) Primer
- 3) Chromate layer
- 4) Zinc based metallic coating
- 5) Steel sheet
- 6) Zinc based metallic coating*
- 7) Chromate layer
- 8) Primer
- 9) CFC-free polyurethane (water blown), Flame retardant DIN4102-B2
- 10) Reinforcement strips

1.3.3 Vertical cross-section

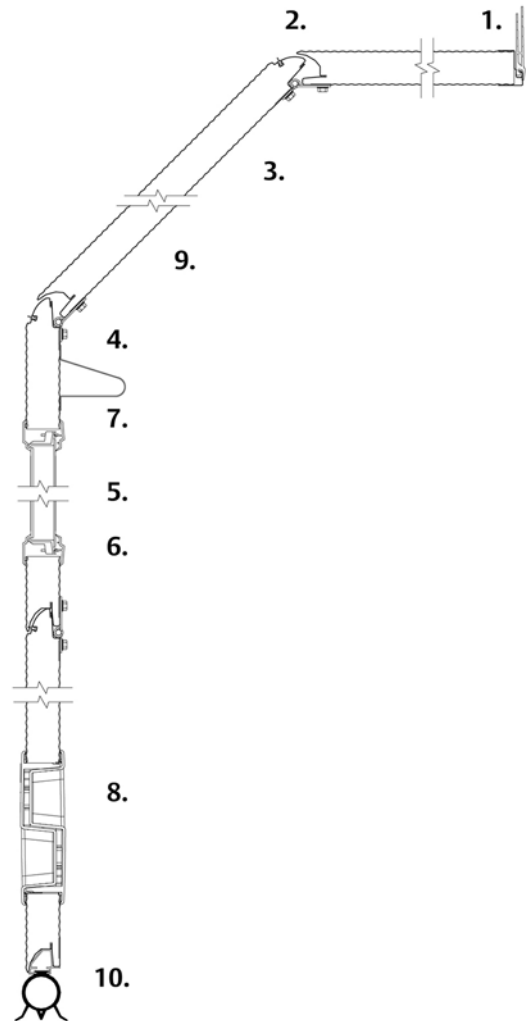

- 1) Top seal
- 2) Section joint with finger pinch protection and seals
- 3) Inner and outer sheet
- 4) Internal steel reinforcement, to provide positive fixing points
- 5) Window (optional)
- 6) High impact polystyrene or aluminium window frame
- 7) Panel truss - wind reinforcement (if necessary)
- 8) Step/lift handle
- 9) Insulation (CFC-free / water blown)
- 10) Bottom seal

1.3.4 Colors

The RAL-colors are as close as possible to the official RAL HR collection. Max. deviation is 1,0 ΔE (RAL 7016 excluded).

Pre-coated range:



RAL 1021



RAL 3000



RAL 5003



RAL 5010



RAL 6005



RAL 7016



RAL 7021

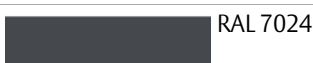

RAL 7024

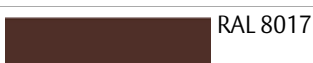

RAL 8017



RAL 9002

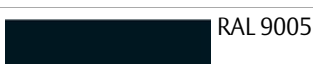

RAL 9005



RAL 9006



RAL 9007

RAL 9010

1.3.4.1 Pre-coated colors

- Outside color: The steel panel is available in the 14 standard RAL colors
- Inside color: RAL 9002 - Grey white.

1.3.5 Seals

The door is equipped with well designed seals on all sides that gives the door its excellent sealing abilities.

1.3.5.1 Top seal

Installed on the top panel to seal the gap between the panel and the wall. The double lip EPDM rubber top seal is mounted in an ABS adapter profile for optimal insulation and tightness.

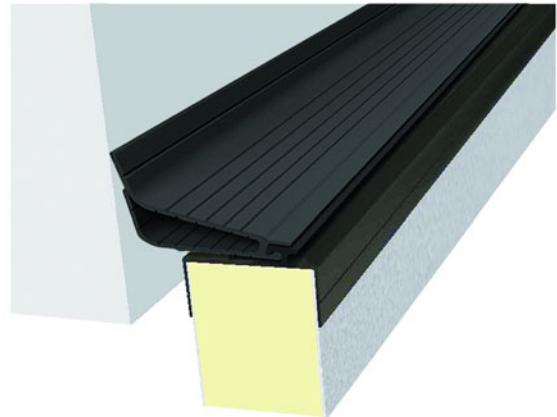

1.3.5.2 Side seal

Installed on the track set to close the gap between the tracks and the door leaf. The double lip side seal design with insulation chambers ensures an optimal insulation and sealing.

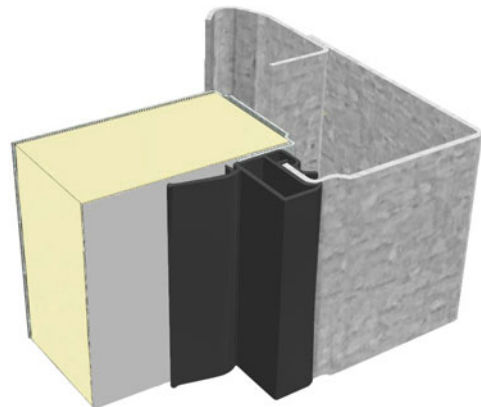

1.3.5.3 Bottom seal

Installed on the bottom edge of the bottom panel, to act as a barrier as well as a shock absorber. The flexible EPDM rubber material and the O-shape provides continuous pressure on the floor, ensuring maximum sealing. The bottom seal is mounted in an ABS adapter for optimal insulation and reduced risk of condensation.

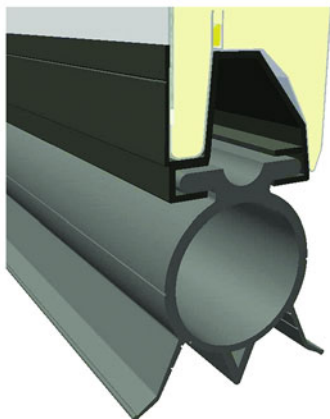

1.3.6 Wind reinforcement truss

Wider door panels and panels with windows are reinforced with metal profiles that act as trusses. These trusses reduce bending of the panel caused by wind loads or when the door leaf is in the horizontal position and is bending under its own weight. The truss is sloped to prevent objects being placed on it which could fall when the door opens. Nice plastic endcaps prevent dust being collected in the truss.

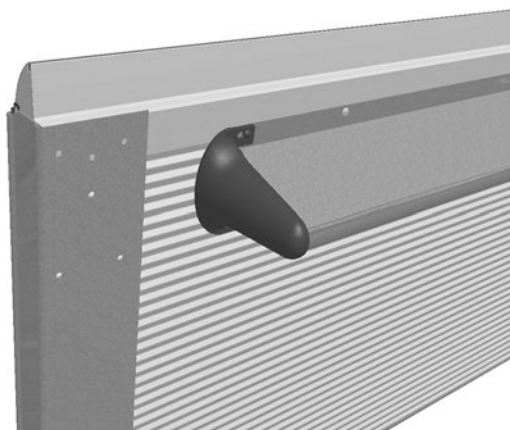

1.3.6.1 Wind reinforcement truss

For safety reasons wind reinforcements are not possible on section 1, 2 and 3.

1.3.7 Handle

For manual operation, every ASSA ABLOY OH1042S overhead sectional door is provided with a solid, easy to grip and step-on handle, finished with the ASSA ABLOY logo.

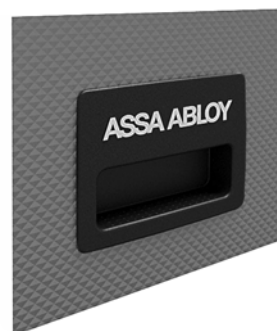

1.3.8 Lock bolt

A standard ASSA ABLOY OH1042S overhead sectional door is equipped with a lock bolt. The lock bolt locks the door from the inside, without the use of a key. The lock bolt has a hole in the latch, to allow the use of a 12mm padlock.

The lock bolt is not visible from the outside.

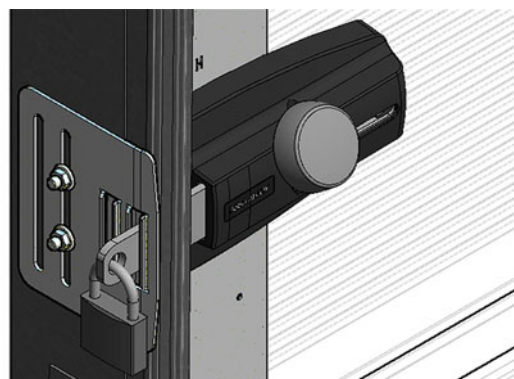

1.4 Balancing system

The balancing system balances the door by applying a force nearly equal to the weight of the door leaf. This allows the door leaf to be moved up and down manually, and to stay open in any position.

The system is installed on the top or the end of the track set and works as follows: Two torsion springs are installed on a shaft above the door opening. This shaft has a cable drum on each end from which door cables run to the bottom corners of the door leaf. Turning the shaft moves the door up or down.

1.4.1 Safety devices

The balancing system supports heavy forces. In case of a spring or cable break, its counterforce is lost. The door is therefore equipped with two safety devices that can block downward door movement:

- Spring Break Device (standard)
- Slack Rope Switch (standard)

1.4.1.1 Spring break device (SBD)

The Spring Break Device (SBD) is delivered with all ASSA ABLOY OH1042S overhead sectional doors.

In the event of a spring break, the sudden drop force activates the Spring Break Device (SBD). The shaft will be locked in less than 300 mm of door movement.



1.4.1.2 Slack rope switch

The Slack Rope Switch is delivered with all ASSA ABLOY OH1042S overhead sectional doors.

In the event of a cable break, the sudden drop of tension activates the Slack Rope Switch. The motor will not be able to continue to run.

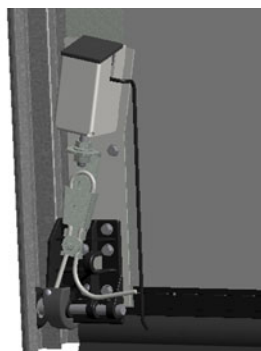

1.5 CEN Performance

1.5.1 Lifetime expectation

Door: 200.000 door cycles or 10 years, if service/replacement program is performed
Springs: 20.000 door cycles, optional max.100.000 depending door configuration.

1.5.2 Resistance to windload

EN12424

Test result	Class 3	
Class	Pressure Pa (N/m ²)	Specification
0	-	No performance determined
1	300	
2	450	
3	700	
4	1000	
5	> 1000	Exceptional : Agreement between manufacturer and supplier

1.5.3 Resistance to water penetration

EN12425

Test result	Class 3	
Class	Pressure Pa (N/m ²)	Specification
0	-	No performance determined
1	30	Waterspray for 15 minutes
2	50	Waterspray for 20 minutes
3	> 50	Exceptional : Agreement between manufacturer and supplier

1.5.4 Air permeability

EN12426

Test result	Class 3	
Class	Air permeability dp at a pressure of 50 Pa (m ³ /m ² /h)	
0	-	
1	24	
2	12	
3	6	
4	3	
5	1,5	
6	Exceptional : Agreement between manufacturer and supplier	

1.5.5 Thermal transmittance

EN12428

Thermal transmittance	1,1 W/(m ² ·K) full panel (Door size 4.050 x 4.250 mm) 1,0 W/(m ² ·K) full panel (Door size 5000 x 5000 mm)
-----------------------	--

(Door size 5000mm x 5000mm)

1.5.6 Acoustic insulation

ISO 10140-2

Acoustic insulation *	R - 25 dB
-----------------------	-----------

* Door surface 4.000 x 2.500 mm, no passdoor (for other sizes it can differ)

1.5.7 Operating forces and safe openings

EN12453 & EN12604	Crushing force N	Crushing force N	Crushing force N
Opening gap mm	200 mm from lateral border right from outside	In the middle of the door opening	200 mm from lateral border left from outside
50 mm	passed	passed	passed
300 mm	passed	passed	passed

The crushing force is the force needed for the safety edge to be activated. The maximum force allowed, according to EN12453 safety in use of power operated doors is 400 N within a maximum period of time of 0.75s. With standard light curtain there is no crushing force.

1.6 Track sets

1.6.1 General

The track set supports the door leaf on its rollers and guides it upwards. The selection of the appropriate track set is based on various factors:

- Available head room
- Door height
- Type of vehicles
- Presence of roof obstructions, pipes and overhead crane beams.

The track sets below cover most applications. Other applications are available on request.

1.6.2 SL - Standard Lift

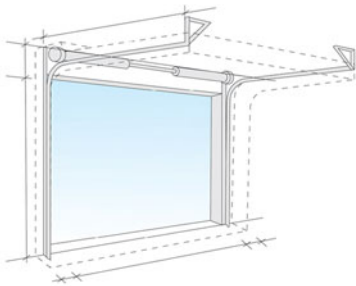

- Building type: Most standard industrial buildings.
 - Benefits: Optimal design for common buildings.
- The Standard Lift track set, with the spring package just above the door, is the most common solution

1.6.3 HL - High Lift

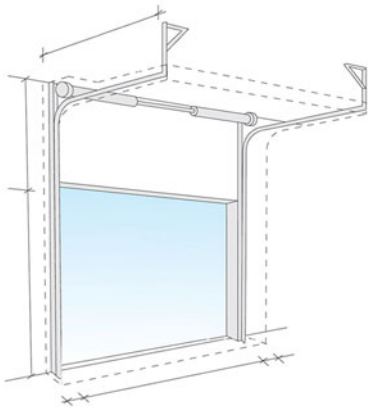

- Building type: High ceilings. On the High Lift track set the spring package is placed high above the door.
- Benefits: This track type allows high vehicles to cross along the door opening without obstructions of the horizontal tracks.

This track type is used when the space above the door is considerable, and is needed for work and traffic, e.g.: high vehicles.

1.6.4 VL - Vertical Lift

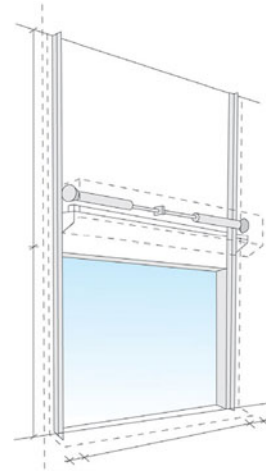

- Building type: Very high ceiling and high working space requirements.
- Benefits: Allows high vehicles to cross along the door opening without any obstructions.

If the space between the daylight height and the roof is sufficient, with this track type, the door can be opened vertically.

2. Available Options

2.1 Fixed sections

Fixed sections can advantageously fill space around new doors that are smaller than the wall opening. Fixed sections are available in top and side sections, with or without windows or passdoor. Fixed sections are supplied in the same color and construction as the door leaf.

A fixed section can be provided with a passdoor for two reasons: Safety and energy cost reduction.

- Safety: Putting a separate passdoor in a fixed section next to the industrial door separates pedestrian and vehicle traffic.
- Energy cost reduction: The opening space for frequent pedestrian traffic is minimized.

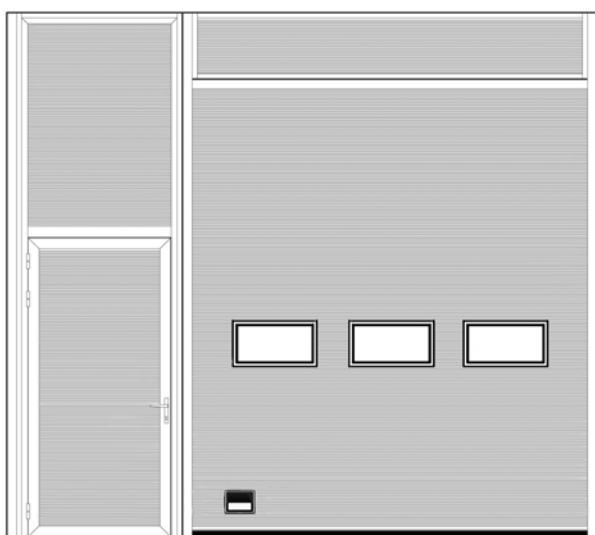

Maximum size in mm
(Daylight width - Daylight height)

Passdoor	1495 - 2440
Side panel with passdoor (A)	1495 - 6000
Side panel with passdoor (B)	2400 - 2076
Side panel with passdoor (C)	2400 - 6000
Side panel without passdoor	2400 - 6000
Side panel without passdoor (loose sections)	8000 - 6000
Top panel (loose sections)	8000 - 6000

2.1.1 Fixed sections options

Minimum size in mm
(Daylight width - Daylight height)

Passdoor	800 - 2076
Side panel with passdoor (A)	800 - 2441
Side panel with passdoor (B)	1496 - 2076
Side panel with passdoor (C)	1496 - 2441
Side panel without passdoor	300 - 300
Side panel without passdoor (loose sections)	83 - 140
Top panel (loose sections)	83 - 83

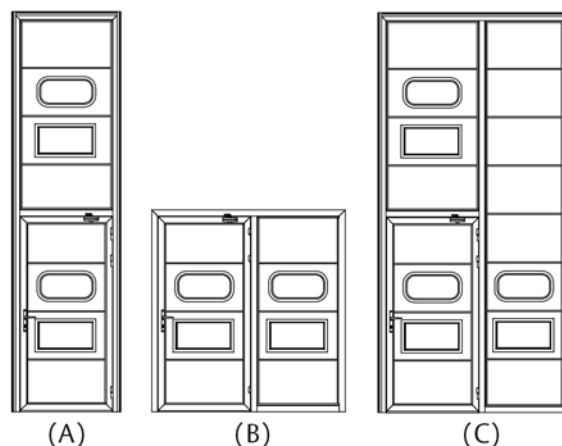

B - C available on request

2.2 Windows

The door sections can be glazed with windows*. The number of windows per section is directly related to the daylight width. Optionally, one single window can be placed on the outer left or right side, in the third section.

*The bottom section cannot be glazed.

2.2.1 DARP

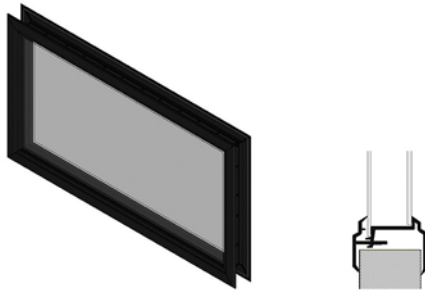

- Double layer Acrylic (3 + 2 mm), Rectangular, in Plastic frame
- Light opening: 604 x 292 mm
- Window frame: Black

2.2.2 TARP

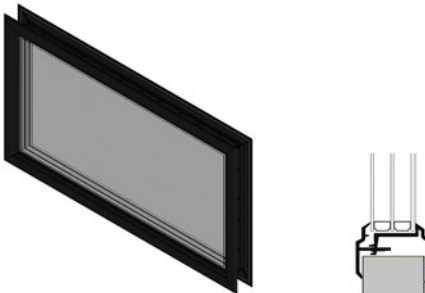

- Three layer Acrylic (3 + 3 + 2 mm), Rectangular, in Plastic frame
- Light opening: 604 x 292 mm
- Window frame: Black

2.2.3 DAOP



- Double layer Acrylic (3 + 2 mm), Oval, in Plastic frame
- Light opening: 610 x 292 mm
- Window frame: Black

2.2.4 ALRB



- Aluminum Layer Rectangular Burglar, double layer (6+6 mm) in aluminum frame
- Light opening: 578,5 x 268,5 mm
- Burglar Resistance Class 2

2.2.5 ALBS



- Aluminum Layer Burglar Small, double layer (6+6 mm) in aluminum frame
- Light opening: 578,5 x 146,5 mm
- Burglar Resistance Class 2

2.2.6 Framed sections

The ASSA ABLOY OH1042S overhead sectional door can be fitted with framed sections. The bottom section is always insulated. The height of the framed sections is 545mm. Only the top-section can have a variable height. For safety reasons, the width of the sections is limited, depending on wind load. For class 3 wind load resistance, trussed profiles are needed. In sections 1, 2 and 3 trussed profiles are never allowed. The glass weight is limited to 12kg/m². For more details please refer to the ASSA ABLOY OH1042F documentation or contact ASSA ABLOY.



2.2.7 Number of windows

For windows the daylight width is divided into a fixed grid. The number of windows depends on the daylight width of the door.

Windows

No. of windows	Daylight width
1	2050 - 2134 mm
2	2135 - 2999 mm
3	3000 - 3864 mm
4	3865 - 4729 mm
5	4730 - 5000 mm

For safety reasons windows are limited in section 2 and 3 at a DLW \geq 4050 mm. For details contact ASSA ABLOY.

Optional: One window in the outer left or right side of section 3 only.

2.2.8 Windows

DARP/TARP/ALRB/ALBS

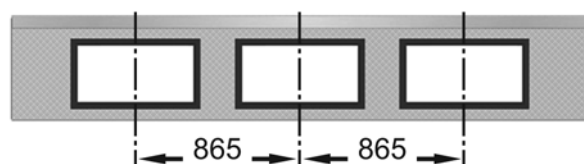

DAOP

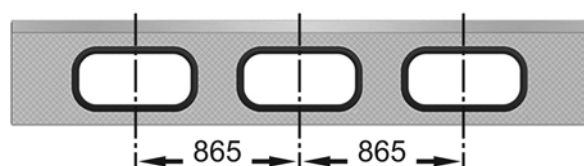

2.3 Optional colors*

Factory painting

The door leaf can be factory painted in any RAL and NCS color plus some metallic colors, outside only. The painting can be applied to only the panel or to the complete door leaf, including frames and strips.

Panel only

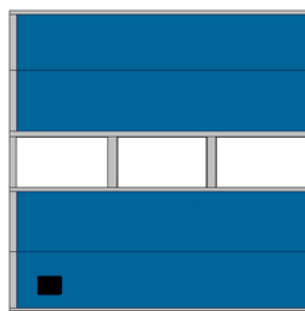

Complete

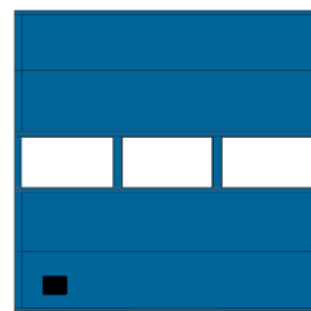

* Other colors available on request

2.4 Cylinder lock

The Cylinder lock is a key operated lock which offers extra security. The lock is installed on the inside and can be unlocked with a key and turning the handle. Access to the Cylinder lock is possible from either only the inside, or both the inside and the outside.



3. Operating system

3.1 Type of operation

An ASSA ABLOY OH1042S overhead sectional door is always electrically operated. If needed the door can be opened and closed manually. Electrically operated doors can be controlled by hand or be fully automatic.

3.2 Electrical operation

The ASSA ABLOY OH1042S overhead sectional door will be supplied with a high performance electrical operating system. This operating system gives access to the full program of Access and Automation functions, that can fulfill many operational needs, related to traffic type and frequency, door weight and temperature control.

3.3 950 Door control system

The 950 Door control system is the most advanced control unit that is prepared for one or more physical upgrades from the entire range of automation systems. An automation system allows door operation by sensors or remote control. This control unit contains a 3-digit diagnostics display that allows efficient troubleshooting and displays the number of door cycles. Together with the service indicator, this extra feature allows advanced maintenance planning to users where the door is an essential element of internal logistics.

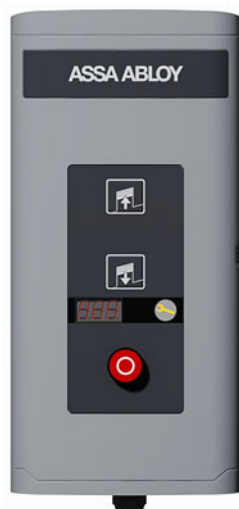

- Dimensions: 300 x 400 x 165 mm (wxhxd)
- Standard actuator UP-STOP-DOWN and pulse control
- Self monitoring light grid.
- Automatic closing after set period 0-240s.

3.4 CMD9S Operator

A main part of the system is the CMD9S operator: an electric motor which drives the balancing shaft with the cable drums and torsion springs. The CMD9S operator is mounted directly on the balancing shaft and does not require any special wall reinforcement.

Key features:

- Smooth and silent
- Soft start and soft stop
- Shaft: ø35 mm tube



CMD9S Operator	
Voltage supply: +/- 10%	230V AC, +/- 10% 1-phase 50/60Hz
Power:	0,55 kW
Degree of protection:	IP65, with CEE plug, IP 44
Allowed door weight, max.:	300 kg
Temperature working range:	-20°C to +55°C*
Operating factor:	ED = 30% S3 10 min. intermittent

* At low temperatures the first few cycles may be run with reduced speed to prolong the operator's lifetime. Can be equipped with a heater for a working range down to -30°C.

3.5 Guidelines for automation

The “Automation D-kits” are packages of common combinations. These kits can also be supplemented by “additions to D-kits”.

Automation D-kits	D1	D2	D3	D4	D5	D6
Interlocking	■	■	■	■	■	■
Magnetic loop		■		■		■
Traffic lights - Green + Red					■	■
Warning lights - Red	■			■		
Additions to D-kits						
Warning lights – Green	□	□	□	□		
Traffic lights - Green + Red	□	□	□	□		
Relay box	□	□	□	□	□	□
Radar	□	□	□	□	□	□

■ Standard □ Option / Available

3.6 Access and automation

ASSA ABLOY offers a wide range of functions that allows advanced opening and safety control. Please refer to the specification sheet of the control units to see which functions apply to which models.

3.6.1 Basic control functions

3.6.1.1 Interlocking

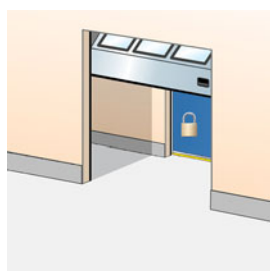

Developed for climate control or safety; If door A is open, door B cannot be opened. If door B is open, door A cannot be opened. An interlocked door can remember an up-command, if selected via a micro switch.

3.6.1.2 Reduced opening

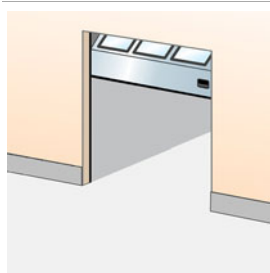

When it is unnecessary or undesirable to fully open a door, an additional switch can be used to open the door to a pre-programmed reduced opening position.

3.6.2 External control functions

3.6.2.1 External push button box

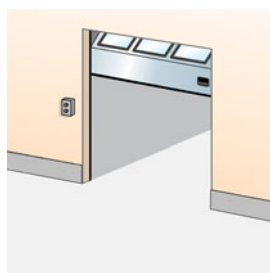

An extra control box is installed outside the building or inside close to the door if the main control unit needs to be installed away from the door opening. Installed on the inside or outside wall beside the door.

3.6.2.2 Pull-rope switch

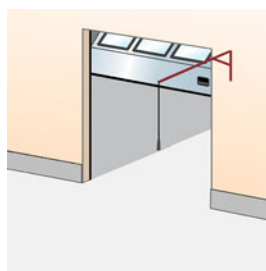

A pull-rope switch above the door opening can be operated from e.g. a forklift truck. Pulling the rope opens a closed door or closes an opened door. Installed on the inside construction above the door.

3.6.2.3 Remote control

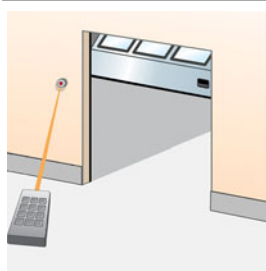

A hand-held radio transmitter allows door operation from a vehicle or any position within 50-100 meters from the receiver and aerial at the door. For closing, the door can be provided with a photocell beam. Receiver installed in control unit, antenna installed on the wall beside the door.

3.6.3 Automatic control functions

3.6.3.1 Magnetic loop

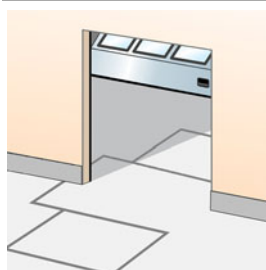

A sensor in the floor detects a metal object (usually forklift trucks, pallet trucks) and opens the door automatically. This is an ideal solution for frequent vehicle traffic. Installed on the outside, inside or both sides of the door in the floor.

3.6.3.2 Radar

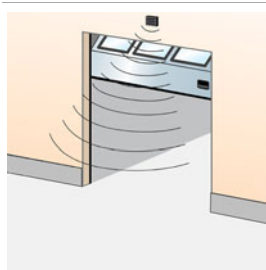

An infrared sensor above the door detects an object (person, vehicle) within a specified distance from the door and opens the door automatically. This is an ideal solution for frequent vehicle or personal traffic. Often combined with automatic closing. Installed on the inside or outside wall above the door.

3.6.3.3 Photocell open door

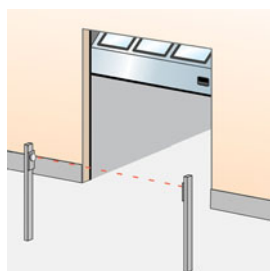

A set of photocells on pillars, on each side of the door. When a person or vehicle passes between the photocells, the beam is interrupted and the door opens. Photocells installed on pillars, away from the door.

3.6.4.3 Warning lights - Red

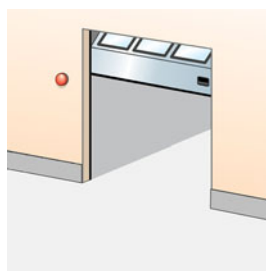

Two red warning lights giving information on the current door behaviour. Flashing light before or during door movement. Optional: Continuous light before and during door movement. Installed on the inside and outside wall beside the door.

3.6.3.4 Automatic closing

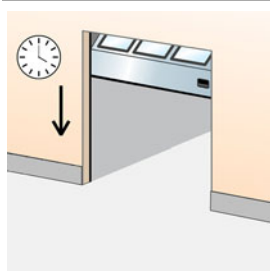

A programmable timer that closes the door after a specified time, counted from either the fully open position and/or from passing through the photocell beam. Adjustable micro switches in control unit.

3.6.4.4 Warning lights - Green

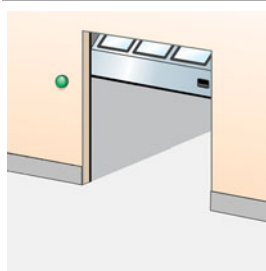

One or two green warning lights indicating the open position of the door by continuous light signal. Installed on the inside and/or outside wall beside the door.

3.6.4 Safety functions

3.6.4.1 Safety photocells 1-channel

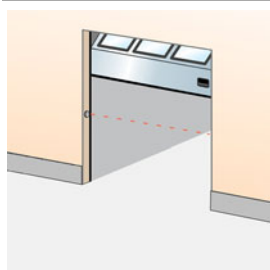

A set of a photocell transmitter and receiver is installed in the door opening. If the photocell beam is interrupted during closing, the door will stop in less than 30mm and reverse to the fully open position. Installed in the door opening.

3.6.4.5 Traffic lights - Red & Green

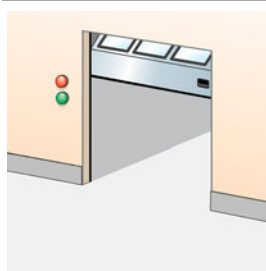

If traffic through a door needs to be directed; two red and two green traffic lights can be installed to indicate traffic direction. From the side where a vehicle is first detected to approach the door, the green traffic light comes on. The opposing side shows a red traffic light. Traffic from this direction must give way to the other. Usually installed in e.g. parking garages. Installed on the inside and outside wall beside the door.

3.6.4.2 Light curtain

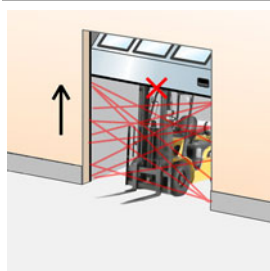

The speed door is standard equipped with a light curtain. These strips of photocells in the tracks detect any obstruction under a closing door and reverse the door.

3.6.5 Additional functions

3.6.5.1 UPS battery backup



When mains failure cannot be permitted or an increased risk of mains failure is predicted, the UPS battery backup system can be installed to store enough energy for 5 door cycles.
Installed on the inside wall beside the door.

3.6.5.2 Relay box



A sealed connection box makes it possible to safely connect external high-voltage equipment.

4. Building and space requirements

4.1 Building preparations

4.1.1 Installation preparations

The ASSA ABLOY OH1042S overhead sectional door is shipped in parts and installed on-site. All necessary installation material is included. For every track type ASSA ABLOY offers specific installation kits to position the door in the building facade.

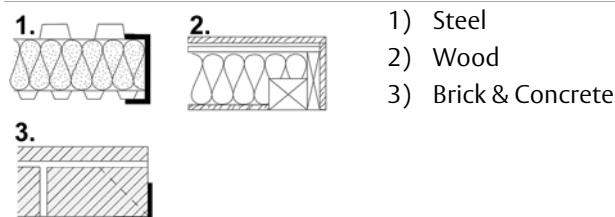

4.2 Space requirements

DLH	= Daylight Height	The height of the clear opening
DLW	= Daylight Width	The width of the clear opening
D	= Depth	The space between the inner side of the wall and the end of the horizontal track construction
h	= Excess height	The extra space required above the daylight height.
SL	= Side space Left	The space required for tracks beside the daylight width.
SR	= Side space Right	The space required for tracks beside the daylight width.

The grey marked area in the illustrations shows the free space required by door movement. Extra space requirements for electrically operated doors are stated in the operator specifications.

4.2.1 Space requirements SL

DLW	≤ 5000 mm
DLH	≤ 5000 mm
h	510 mm
SL/SR	165 mm, 315 mm on operator side
D	DLH + 600 mm

For details see the specific building preparation drawings.

Side and top view

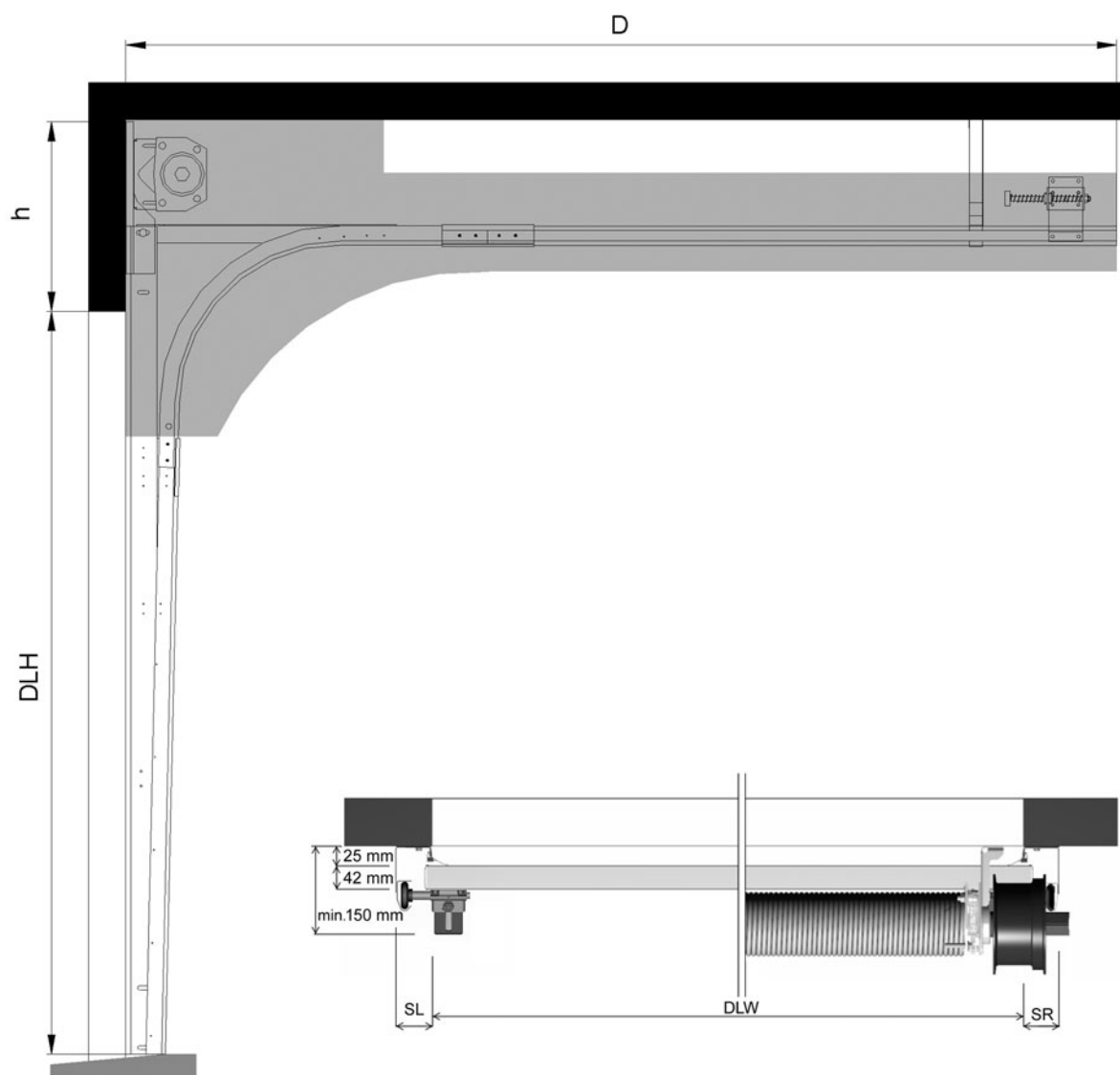

4.2.2 Space requirements HL

DLW	≤ 5000 mm
DLH	≤ 5000 mm
h	HL + 370 mm
SL/SR	165 mm, 315 mm on operator side
D	DLH - HL + 950 mm

We would advise the following doors to be installed on a frame, equipped with an A-65 top seal.

- Doors $DLW \geq 4050$ mm with a dark outside colour, frequently exposed to solar heat.
- For details see the specific building preparation drawings.

Side and top view

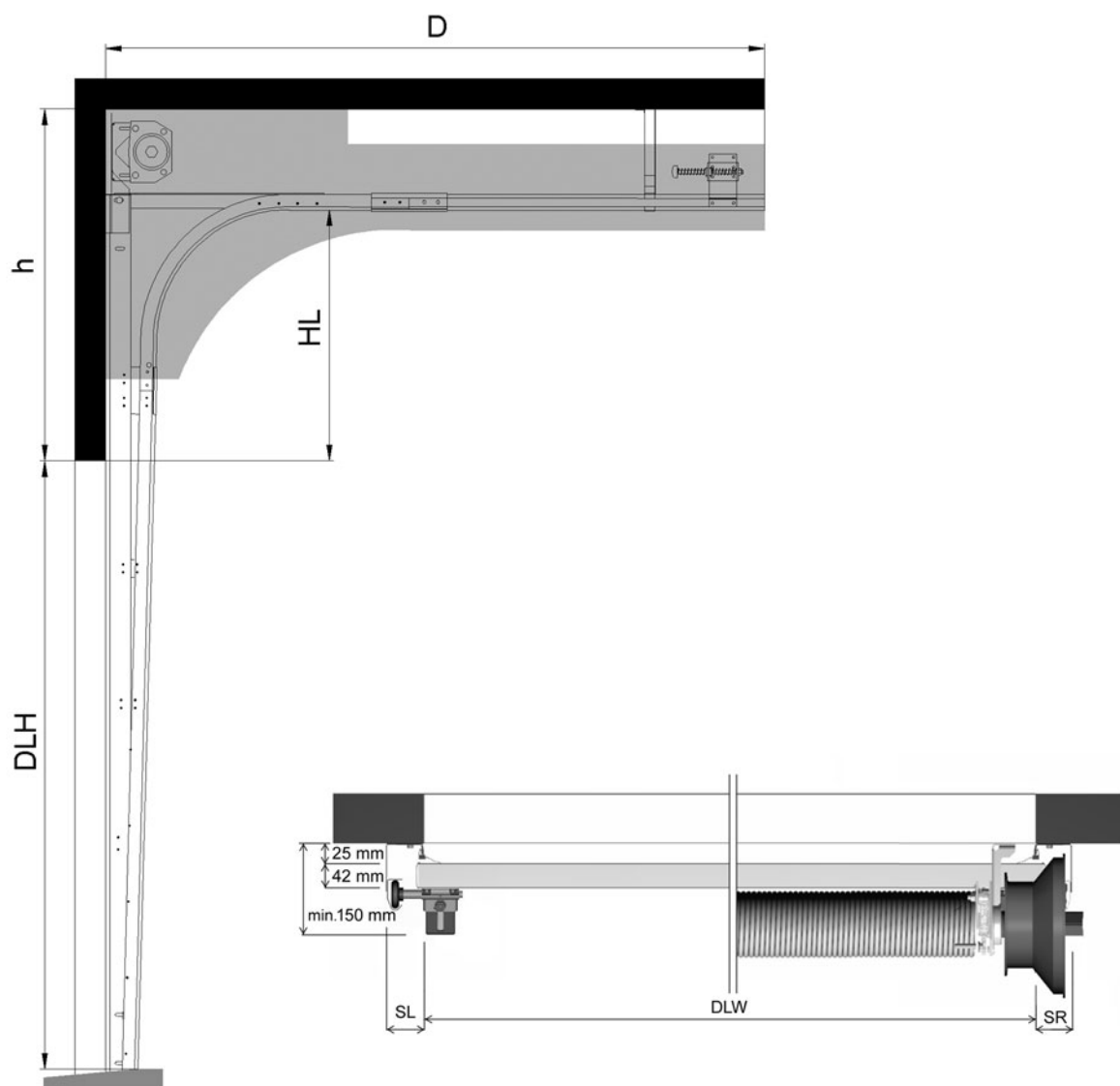

4.2.3 Space requirements VL

DLW	≤ 5000 mm
DLH	≤ 5000 mm
h	DLH + 560 mm
SL/SR	165 mm, 376 mm on operator side
D	VLS = 525 mm

We would advise the following doors to be installed on a frame, equipped with an A-65 top seal.

- Doors $DLW \geq 4050$ mm with a dark outside colour, frequently exposed to solar heat. For details see the specific building preparation drawings.

Side and top view

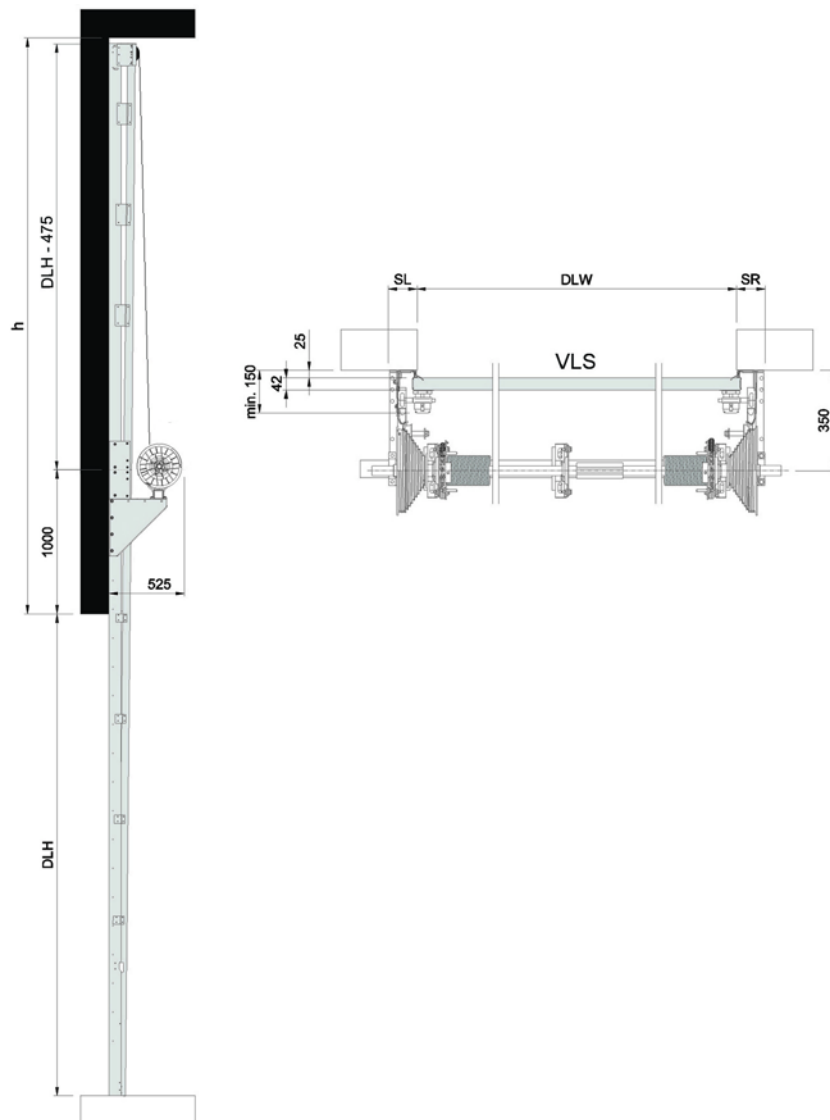

5. Service you can rely on



Gold

The ultimate protection

With full coverage, Gold Service enables you to plan and budget your expenses annually.

- Spare parts for emergency calls
- Labor and travel costs for emergency calls
- Replacement of components according to preventive maintenance schedule and to fulfill legislative and safety requirements



Silver

Added advantages

With cover for all service calls during business hours, Silver Service offers you peace of mind.

- Labor and travel costs for emergency calls
- Preventive maintenance



Bronze

Scheduled Service

With scheduled on site visits, Bronze Service means you know that your doors and docking systems will be regularly serviced and inspected.

- Preventive maintenance

Included in all packages

1-4 scheduled maintenance visits per year	24/7 priority service hotline and fast response	Safety, compliance and quality control checks	Documentation reports provided on site
---	---	---	--

Expert service you can rely on

A healthy business enjoys a steady flow of goods, services and people through its entrances every day. But heavy traffic puts entrances under pressure as every component works to keep them running.

ASSA ABLOY Entrance Systems offer the industry's most complete, flexible service solutions. Because even something as robust and well-engineered as an ASSA ABLOY door or docking system needs to be serviced to stay in great working order.

Pro-active care packages

An ASSA ABLOY service agreement gives you service you can rely on. We have specialized local service technicians on call to take care of your service needs. Equipped with a wide range of spare parts and expertise, to keep your industrial doors and docking systems running.

With an ASSA ABLOY service agreement you can ensure reliable, safe and sustainable operations at every entrance under your agreement, including doors and docking systems, independent of brand.

ASSA ABLOY e-maintenance™ (optional add-on)

For an online overview of your entrance systems and history, add ASSA ABLOY e-maintenance™ to your service package for:

- Easy access to real-time data on all your doors
- Planning, order and service information
- Overview that helps you control lifecycle costs

Index

Numerics

950 Door control system 18

A

Access and automation 20

Acoustic insulation 12

Additional functions 22

Air permeability 11

ALBS 15

ALRB 15

Automatic closing 21

Automatic control functions 20

Available Options 14

B

Balancing system 10

Basic control functions 20

Bottom seal 9

Building and space requirements ... 23

Building preparations 23

C

CEN Performance 11

CMD9S Operator 18

Colors 8

Construction 6

Copyright and Disclaimer Notice 2

Cylinder lock 17

D

DAOP 15

DARP 15

Daylight width and daylight height ... 6

Description 6

Dimensions 6

Door leaf 6

E

Electrical operation 18

External control functions 20

External push button box 20

F

Features 3

Fixed sections 14

Fixed sections options 14

Framed sections 16

G

General 6, 13

Guidelines for automation 19

H

Handle 9

HL - High Lift 13

I

Installation preparations 23

Interlocking 20

L

Lifetime expectation 11

Light curtain 21

Lock bolt 9

M

Magnetic loop 20

Material 7

N

Number of windows 16

O

Operating forces and safe openings 12

Operating system 18

Optional colors* 16

P

Performance 3

Photocell open door 21

Pre-coated colors 8

Pull-rope switch 20

R

Radar 20

Reduced opening 20

Relay box 22

Remote control 20

Resistance to water penetration 11

Resistance to windload 11

S

Safety devices 10

Safety functions 21

Safety photocells 1-channel 21

Seals 8

Section sizes 6

Service you can rely on 27

Side seal 8

SL - Standard Lift 13

Slack rope switch 10

Space requirements 23

Space requirements HL 25

Space requirements SL 24

Space requirements VL 26

Spring break device (SBD) 10

T

TARP 15

Technical Overview 3

Thermal transmittance 12

Top seal 8

Track sets 13

Traffic lights - Red & Green 21

Type of operation 18

U

UPS battery backup 22

V

Vertical cross-section 7

VL - Vertical Lift 13

W

Warning lights - Green 21

Warning lights - Red 21

Wind reinforcement truss 9

Windows 15, 16

The ASSA ABLOY Group is the global leader in access solutions.
Every day, we help billions of people to experience a more open world.

ASSA ABLOY
Entrance Systems

ASSA ABLOY Entrance Systems provides solutions for efficient and safe flow of goods and people. Our offering includes a wide range of automated pedestrian, industrial and residential doors, loading dock equipment, perimeter fencing and service.